

REV / ISSUE	DATE	DESCRIPTION

CONSULTANT

CONSULTANT

MPEP

MPEP pllc
 120 Broadway, 20th Floor
 New York, New York 10271
 tele. 212.477.6366
 fax. 212.346.0813

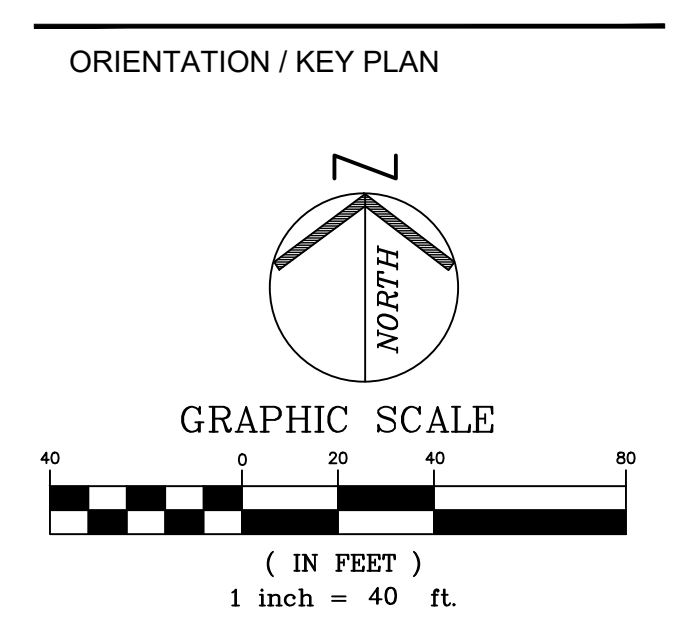

PS&S PAULUS, SOKOLOWSKI AND SARTOR ENGINEERING, P.C.

3 MOUNTAINVIEW ROAD
 P.O. BOX 4039
 WARREN, NJ 07059
 PHONE: (732) 560-9700

THIS IS A PRELIMINARY PLAN. THE CONTRACTOR SHALL BE RESPONSIBLE FOR VERIFYING THE ACCURACY OF ALL DATA AND INFORMATION PROVIDED TO HIM BY THE CLIENT AND FOR OBTAINING ALL NECESSARY PERMITS AND APPROVALS FROM THE APPROPRIATE AGENCIES. THE CONTRACTOR SHALL BE RESPONSIBLE FOR OBTAINING ALL NECESSARY PERMITS AND APPROVALS FROM THE APPROPRIATE AGENCIES. THE CONTRACTOR SHALL BE RESPONSIBLE FOR OBTAINING ALL NECESSARY PERMITS AND APPROVALS FROM THE APPROPRIATE AGENCIES.

JOSEPH J. FLEMING, P.E.
 PROFESSIONAL ENGINEER
 N.Y. LIC. NO. 66591

SIGNATURE _____ DATE _____

CLIENT _____

RXR GLEN ISLE PARTNERS LLC

PROJECT
GARVIES POINT WATERFRONT REDEVELOPMENT PHASE II B BLOCKS D-E-F
 CITY OF GLEN COVE, NASSAU COUNTY, NEW YORK

SHEET TITLE
BLOCKS D, E & F SUBDIVISION OVERLAY

JOB NO.: 03610-0009
 DATE: 03/25/2021
 DRAWN: BSL
 CHECK: PAR/JJF
 SCALE: 1"=40'

BINDING ORDER:
 SHEET OF _____
 SHEET NO.